



T O O L I N G

MINIMILL







# CERTIFICATO DEL SISTEMA DI GESTIONE PER LA QUALITÀ QUALITY MANAGEMENT SYSTEM CERTIFICATE

Si dichiara che il sistema di gestione per la Qualità dell'Organizzazione:  
We certify that the Quality Management System of the Organization:

**GE TOOLING S.r.l.**

Registrazione no/Registration no:

1238 - A

Indirizzo/Address:

Via Elsa Morante, 71  
41100 Modena Italia

È conforme alla norma/Is in compliance with the standard:

**UNI EN ISO 9001:2000**  
ISO 9001:2000

Per i seguenti prodotti/servizi/For the following products/services:

**Commercializzazione utensileria meccanica di precisione**  
*High precision metal cutting tools trading*

EA: 29 a

Il mantenimento della certificazione è soggetto a sorveglianza annuale e subordinato al rispetto dei requisiti essenziali CERMET.  
*Maintenance of the certification is subject to annual survey and dependent upon the observance of CERMET basic requirements.*

Riferirsi al manuale qualità per i dettagli delle esclusioni ai requisiti della norma UNI EN ISO 9001:2000  
*Refer to quality manual for details of exclusion of ISO 9001:2000 requirements*

Data rilascio certificato/Certificate issuance date: 1999-11-09  
Data ultima modifica/Last modification date: 2007-06-05  
Data prossimo rinnovo/Following renewal date: 2010-04-30

Direttore Generale/General Manager  
Ing. Rodolfo Trippodo

**SINCERT**

ACCREDITAMENTO ORGANISMI DI CERTIFICAZIONE E ISPEZIONE

SGQ N° 007A  
SGA N° 0100  
PRD N° 069B  
SSI N° 006G

Membro di MLA EA per gli schemi di accreditamento SGQ, SGA, PRD, PRS e ISP e di MLA IAF per gli schemi di accreditamento SGQ, SGA, e PRD  
Signatory of EA MLA for the accreditation schemes QMS, EMS, Product, Personnel and Inspection and of IAF MLA for the accreditation schemes QMS, EMS and Product

**CERMET**  
Certification and research for quality

# Frese per smussi, scanalature a V e centrare 45°

Fas- und Zentrierfräser 45°

Center drilling, chamfering and V groove cutting 45°

ART. 311 W

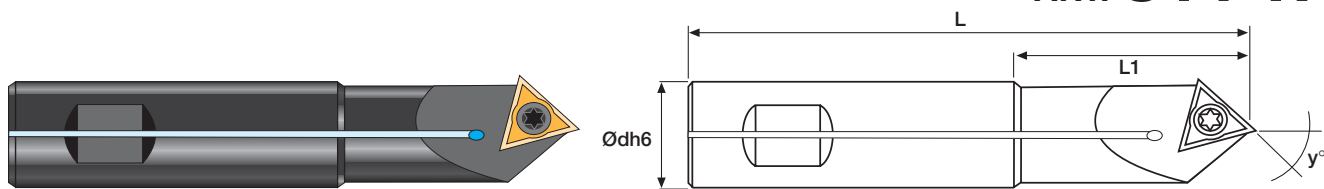

CENTRATURA ZENTRIER-SENK CENTER DRILLING

SMUSSO SU FORO BOHRUNG ANFASEN BORE CHAMFERING

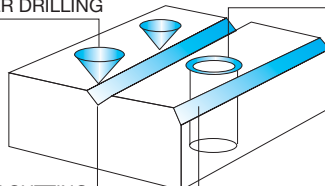

SCANALATURA "V" "V"-NUTENFRAESER "V"-GROOVE CUTTING

SMUSSO LATERALE ECKE ANFASEN CORNER CHAMFERING

Codice d'ordine Bestell-Nr. Order No.	(mm) Dimensioni - Abmessungen - Dimensions									
	dh6	L	L1	y°	Z	D.min	D.max			
311.020 WW	20	115	40	45°	1	0,2	20	TCMX 16T3ZR	VT 40	BT 15
311.020 WWL	20	150	60	45°	1	0,2	20			
311.020 WXL	20	200	80	45°	1	0,2	20			

W-W = Con fori di lubrificazione

W-W = Kühlmittelbohrung

W-W = Coolant Bores

## Frese per smussi e svasature

Fräser für Abschrägung Spitzensenkung

Milling cutter for chamfering flarin

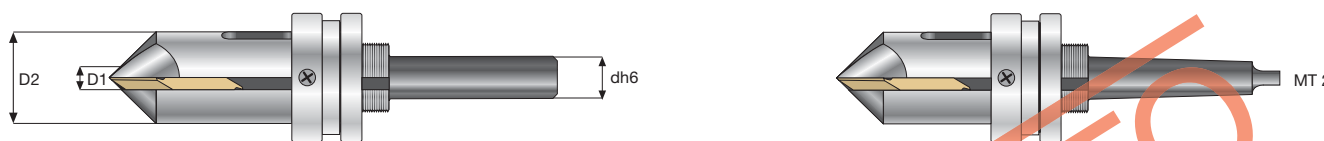

Codice d'ordine Bestell-Nr Order No.	(mm) Dimensioni - Abmessungen - Dimensions				Inserti Wenderplatten Inserts	Angolo Taglio Schneidewinkel Chamfering Angle	Angolo Spoglia Freiwinkel Rake Angle
	D1	D2	dh6	Z			
CS - 18 - 2	2	18	10	1	CS 18 T	90°	0° Ghisa Guss Cast Iron
CS - 25 - 2	2	25	12	1	CS 25 T		14° Acciaio Stahl Steel
CS - 42 - 2	2	42	MT 2	1	CS 42 T		20° Alluminio Alluminium Aluminium

## ESEMPIO D'ORDINAZIONE - BESTELLUNGS BEISPIEL - ORDER EXAMPLE :

FRESA  
FRAESER  
MILLING  
BODY  
CS-25-2

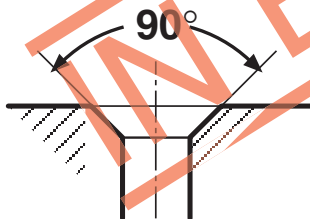

INSERTO  
WENDEPLATTE  
INSERT  
CS-25T 90°-14°

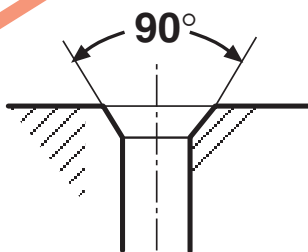

ANGOLO  
SPOGLIA  
FREI WINKEL  
RAKE ANGLE

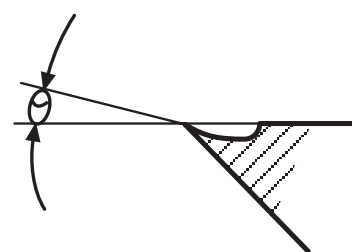



# Frese per cave a T

## Fräser für T nuten

### T slot milling cutter

ART. 250 W

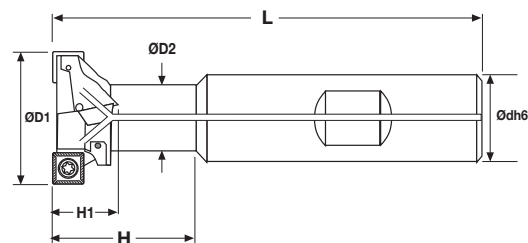
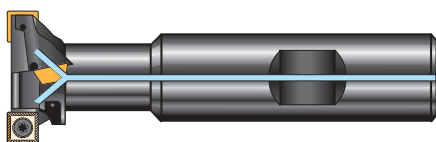

NOTE:

- Per cave a "T" secondo norme DIN 650-UNI 4788-ISO 299
- Für "T" Nuten nach DIN 650-uni 4788-ISO 299 Normen
- For "T" slot cutters according to DIN 650-UNI 4788-ISO 299 norms

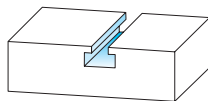

Codice d'ordine Bestell-Nr Order No.	(mm) Dimensioni - Abmessungen - Dimensions										
	ØD1	ØD2	L	H	H1	Ødh6	K	Z			
250.021 WW	21	11	76	26	9	16	1	2	SPMT 060304	VT 25	BT 08
250.025 WW	25	13	82	31	11	16	2	4			
250.032 WW	32	17	88	38	14	20	2	4	SPMT 09T308	VT 35	BT 15
250.040 WW	40	21	108	50	17	25	2	4			
250.050 WW	50	27	120	56	22	32	2	4	SPMT 120408	VT 50	BT 20

Z = Numero di eliche / Schraubenanzahl / Number of flutes  
 K = Fattore d' avanzamento / Vorschubfaktor / Factor of feed  
 W-W = con fori di lubrificazione / Kuehlmittelbohrung / Coolant Bores

# Frese foranti

## Bohrnutfräser

### Drilling and mill

ART. 720 W

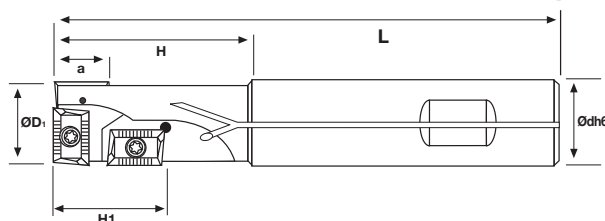

NOVITÀ  
NEU  
NEW

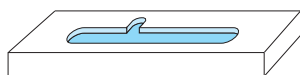

Codice d'ordine Bestell-Nr. Order No.	(mm) Dimensioni - Abmessungen - Dimensions									
	ØD1	Ødh6	L	H	H1	a	Z			
720 WW D.16	16	16	85	30	7	7	2	APKT 0803	VT 25	BT 08
720 WW D.20	20	20	90	35	17	9	3	APKT 1003		
720 WW D.25	25	25	110	50	19	9	3	APKT 1604	VT 40	BT 15
720 WW D.32	32	32	130	50	30	15	3			
<b>Serie lunga - Lange Ausführung / Long models</b>										
720 WWL D.16	16	16	150	30	7	7	2	APKT 0803	VT 25	BT 08
720 WWL D.20	20	20	150	30	17	9	3	APKT 1003		
720 WWL D.25	25	25	150	50	19	9	3	APKT 1604		
<b>Serie extra lunga - Extralange Ausführung / Extralong models</b>										
720 WXL D.20	20	20	180	30	17	9	3	APKT 1003	VT 25	BT 08
720 WXL D.25	25	25	200	50	19	9	3			
720 WXL D.32	32	32	220	50	30	15	3	APKT 1604	VT 40	BT 15

W-W = Con fori di lubrificazione  
 W-W = Kuehlmittelbohrung  
 W-W = Coolant Bores

**Frese per canalini**  
*Fräser für seeger*  
 Milling cutters for seeger grooving

**ART. 150 W**

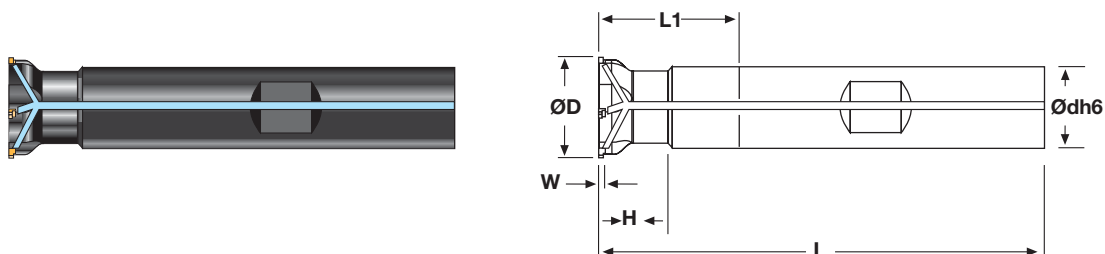

Codice d'ordine Bestell-Nr Order No.	(mm) Dimensioni - Abmessungen - Dimensions									
	ØD	Ødh6	L	H	L1	Z	W			
150.019 WW	19	16	100	20	52	1	1,1-4,15	154.3-16	VT40SG	BT 15
150.034 WW	34	20	125	25	75	3	1,1-4,15	"	"	"

W-W = Con fori di lubrificazione  
 W-W = Kühlmittelbohrung  
 W-W = Coolant Bores

**ART. 150 M**

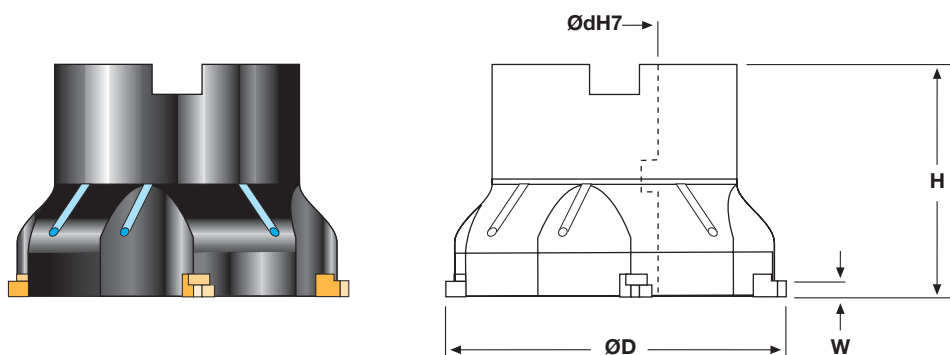

Codice d'ordine Bestell-Nr Order No.	(mm) Dimensioni - Abmessungen - Dimensions							
	Ø	Ødh7	H	Z	W			
150.048 MW	48	16	40	4	1,1-4,15	154.3-16	VT40SG	BT 15
150.063 MW	63	22	40	5	1,1-4,15	"	"	"

W-W = Con fori di lubrificazione  
 W-W = Kühlmittelbohrung  
 W-W = Coolant Bores

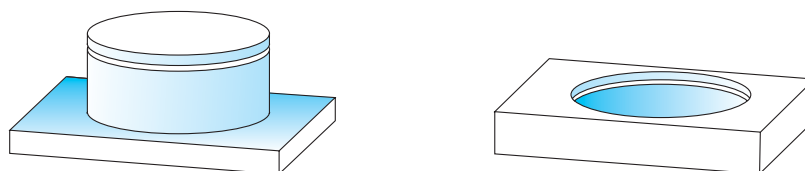



## Frese per smussi e svasature 30°, 45° e 60°

Fräser zum spitzensenken 30°, 45° und 60°

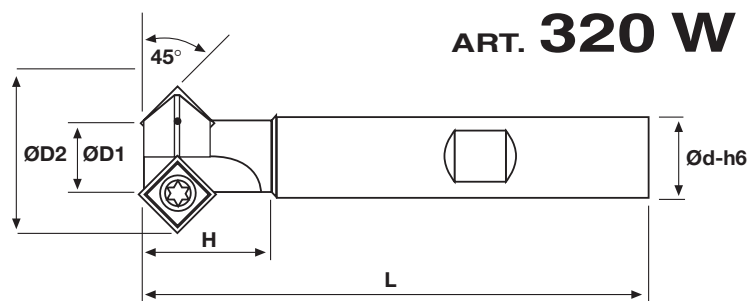
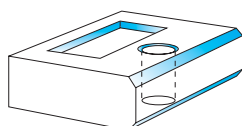
Milling cutter for chamfering 30°, 45° and 60°





ART. **320 W**

Codice d'ordine Bestell-Nr. Order No.	(mm) Dimensioni - Abmessungen - Dimensions								
	ØD1	ØD2	L	H	Ødh6	Z			
320.002 W	2	5	80	30	12	1	CPMT05T1	VT 22	BT 06
320.004 W	4	10	80	28	12	1	SCMT0602	VT 25	BT 08
320.011 W	11	20	80	32	12	2	SCMT09T3	VT 40	BT 15
320.012 W	12	23,7	100	37	20	1			
320.016 W	16	28,8	100	32	16	2			
320.025 W	30	42,3	100	32	20	3			
<b>Serie lunga - Lange Ausführung / Long models</b>									
320.012 WL	12	23,7	200	37	20	1	SCMT09T3	VT 40	BT 15
320.016 WL	16	28,8	200	32	16	2			
320.025 WL	30	42,3	200	32	20	3			

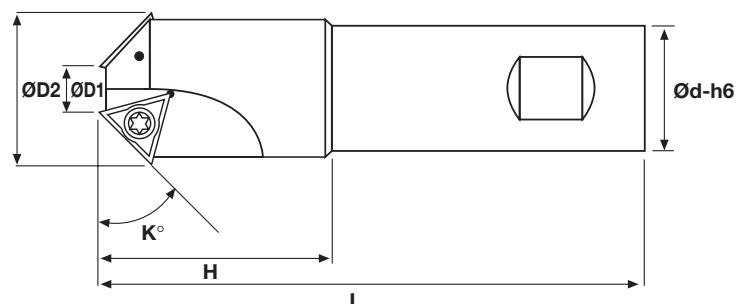
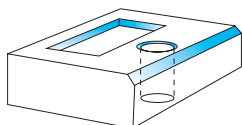
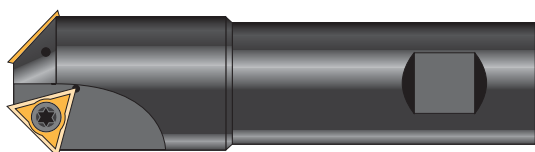
ART. **300 W**

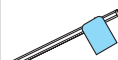

Codice d'ordine Bestell-Nr. Order No.	(mm) Dimensioni - Abmessungen - Dimensions									
	ØD1	ØD2	L	H	Ødh6	Y°	Z			
<b>300 - 45°</b>										
300.016 W	1,2	16	70	20	12	45°	1	TCMT 1102	VT 25	BT 08
300.021 W	6,2	21	90	35	20	45°	2			
300.032 W	10,4	32,5	95	39	25	45°	2			
<b>310 - 60°</b>										
310.016 W	5,4	16	70	20	12	60°	1	TCMT 1102	VT 25	BT 08
310.027 W	14,4	25	90	35	20	60°	2			
310.032 W	17	32,5	95	39	25	60°	2			
<b>315 - 30°</b>										
315.032 W	6	32	95	38	25	30°	2	TCMT 16T3...	VT 40	BT 15

**Frese per smussi e svasature registrabile da 10° a 80°**  
*Frasenfräser, winkelverstellbar von 10° bis 80°*  
 Milling cutter for chamfering-flaring 10° to 80°

**ART. 340 W NEW**

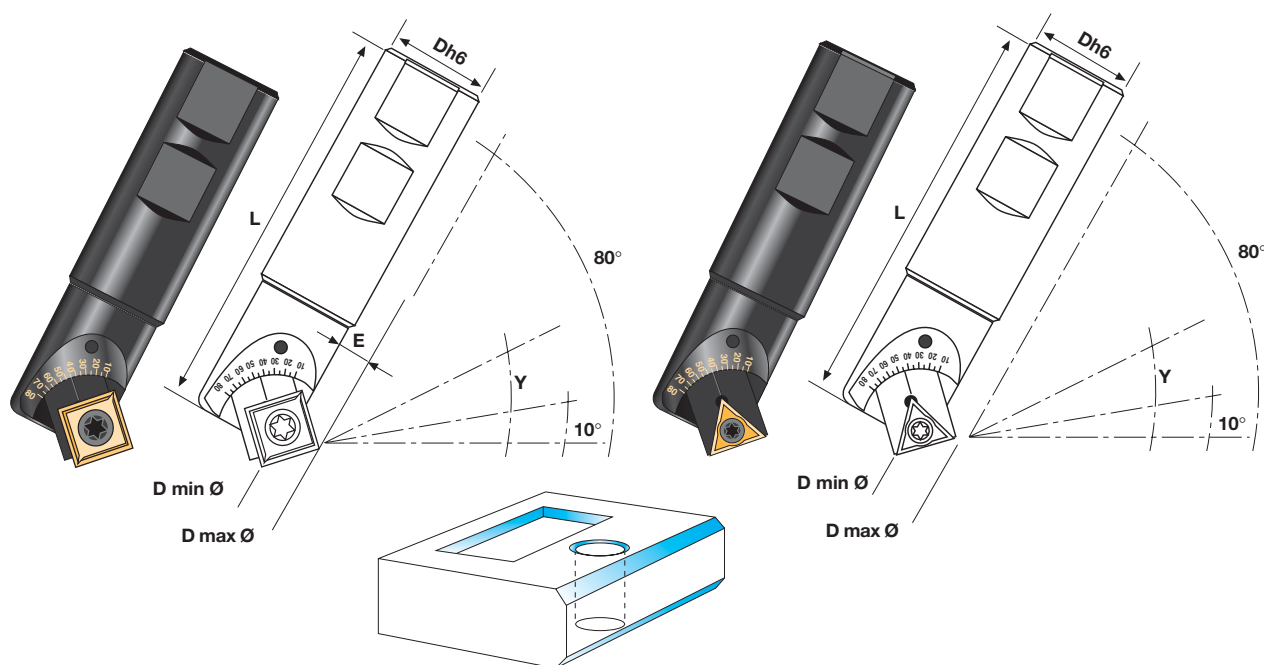

Con cassetta TCMT 16T3 ... Mit Kassette TCMT 16T3 ... With pocket TCMT 16T3 ...

Codice d'ordine Bestell-Nr Order No.	(mm) Dimensioni - Abmessungen - Dimensions									
	D h6	L	Y	D. min. Ø	D. max. Ø					
340 W 025 NEW	25	100	10°	Ø 5	Ø 32	T16 NEW	TCMT 16T3...	VT 40	M6-16	BT 15
340 W 025 NEW	25	100	20°	Ø 6	Ø 33					
340 W 025 NEW	25	100	30°	Ø 7	Ø 34					
340 W 025 NEW	25	100	40°	Ø 10	Ø 33					
340 W 025 NEW	25	100	45°	Ø 11	Ø 33					
340 W 025 NEW	25	100	50°	Ø 13	Ø 32					
340 W 025 NEW	25	100	60°	Ø 16	Ø 31					
340 W 025 NEW	25	100	70°	Ø 19	Ø 29					
340 W 025 NEW	25	100	80°	Ø 23	Ø 27					
340 WL 025 NEW	25	150	"	"	"					
340 WXL 025 NEW	25	200	"	"	"					
340 W 020 NEW	20	100	"	"	"					

Con cassetta SCMT 1204 ... Mit Kassette SCMT 1204 ... With pocket SCMT 1204 ...

Codice d'ordine Bestell-Nr Order No.	(mm) Dimensioni - Abmessungen - Dimensions										
	D h6	L	Y	D. min. Ø	D. max. Ø	E					
340 W 025 NEW	25	100	10°	Ø 7,5	Ø 30	2,7	S 12 NEW	SCMT 1204...	VT 40S	M6-16	BT 20
340 W 025 NEW	25	100	20°	Ø 10	Ø 32	3,6					
340 W 025 NEW	25	100	30°	Ø 13	Ø 32,5	4,3					
340 W 025 NEW	25	100	40°	Ø 16,5	Ø 33,5	4,5					
340 W 025 NEW	25	100	45°	Ø 17,5	Ø 33,5	4,6					
340 W 025 NEW	25	100	50°	Ø 19	Ø 33,5	4,6					
340 W 025 NEW	25	100	60°	Ø 22	Ø 33,5	4,3					
340 W 025 NEW	25	100	70°	Ø 24,5	Ø 33,5	3,8					
340 W 025 NEW	25	100	80°	Ø 27	Ø 31	3					
340 WL 025 NEW	25	150	"	"	"	"					
340 WXL 025 NEW	25	200	"	"	"	"					
340 W 020 NEW	20	100	"	"	"	"					

NB: LE FRESE VENGONO SEMPRE FORNITE CON 2 CASSETTE COMPRESSE T16 NEW + S12 NEW  
 NB: DIE FRÄSER SIND IMMER MIT 2 KASSETTEN GELIEFERT T16 NEW + S12 NEW  
 NB: IN THE MILLING CUTTERS ARE ALWAYS INCLUDED 2 POCKETS

## Set minimill

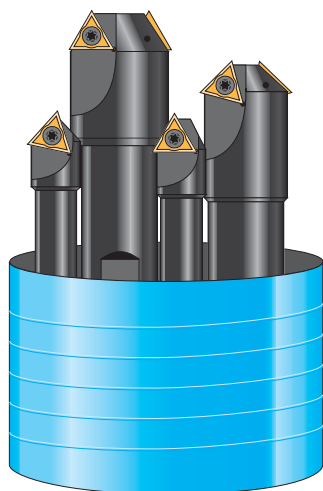

<b>Codice d'ordine Bestell-Nr. Order No.</b>	
<b>Contenuto del set - Inhalt pro Set / Set Contents</b>	
<b>SET 300 W</b>	
1	300.016 W
1	300.021 W
1	310.016 W
1	310.027 W

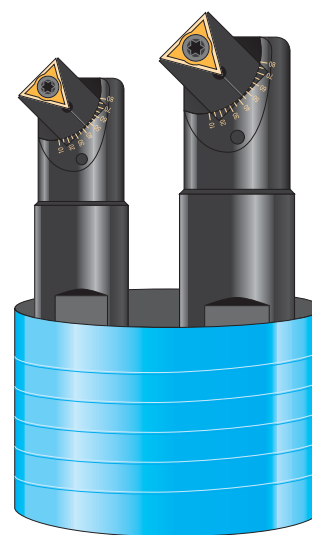

<b>Codice d'ordine Bestell-Nr. Order No.</b>	
<b>Contenuto del set - Inhalt pro Set / Set Contents</b>	
<b>SET FLEXIMILL SK 40</b>	
1	340 W 020
1	330 W 016
<b>SET FLEXIMILL SK 50</b>	
1	340 W 025
1	330 W 020

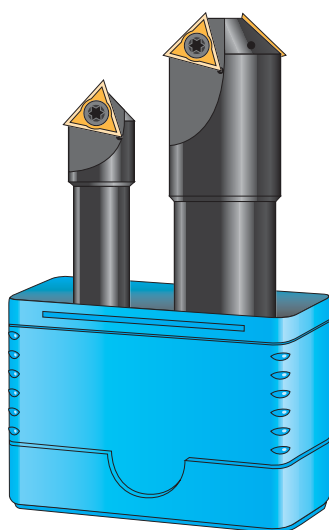

<b>Codice d'ordine Bestell-Nr. Order No.</b>	
<b>Contenuto del set - Inhalt pro Set / Set Contents</b>	
<b>SET 300 W 45°</b>	
1	300.016 W
1	300.021 W
<b>SET 310 W 30°</b>	
1	310.016 W
1	310.027 W

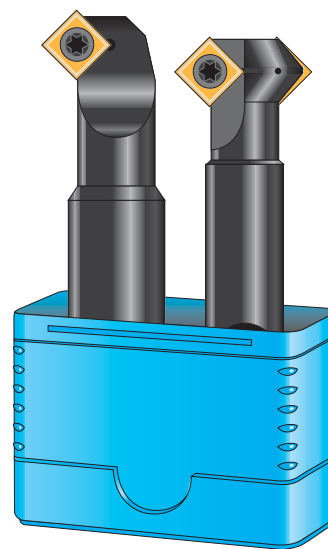

<b>Codice d'ordine Bestell-Nr. Order No.</b>	
<b>Contenuto del set - Inhalt pro Set / Set Contents</b>	
<b>SET 320.012 W 45°</b>	
1	320.012 W
1	320.016 W
<b>SET 320.004 W 45°</b>	
1	320.004 W
1	320.011 W
10	SCMT 060204 TIN



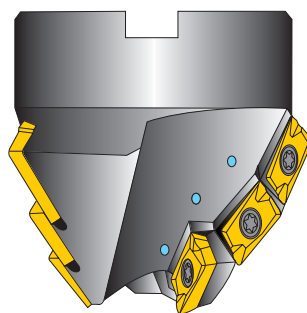
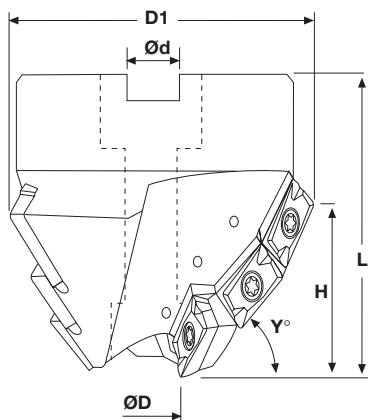

**Frese per smussi 15°, 30°, 45°, 60° e 75°**  
 Frasenfräser 15°, 30°, 45°, 60° und 75°  
 Milling cutter for chamfering 15°, 30°, 45°, 60° and 75°

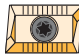

**ART. FB.030**  
 15° - 30° - 45° - 60° - 75°

NOVITÀ  
 NEU  
 NEW

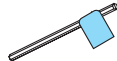

Codice d'ordine Bestell-Nr Order No.	(mm) Dimensioni - Abmessungen - Dimensions										
	D	D1	d	L	Y°	H	Z	K			
FB.030.001 W	17	56	22	50	45	19	9	3	APKT1003 APFT1003 APHX1003	VT 25	BT 08
FB.030.002 W	17	45	16	50	60	24	9	3			
FB.030.003 W	17	65	22	50	30	13	9	3			
FB.030.004 W	17	70	22	50	15	7	9	3			
FB.030.005 W	19	33	16	60	75	27	9	3			

K= Fattore d'avanzamento / Vorschubfaktor / Factor of feed  
 Disponibile a richiesta anche FB 030 con gradazioni differenti Y°  
 Lieferbar auf anfrage FB 030 mit verschiedener graden Y°  
 Available on request FB 030 with different grades Y°

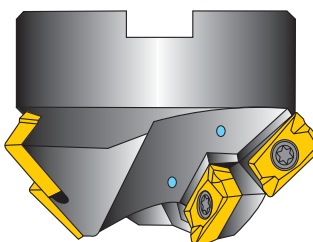
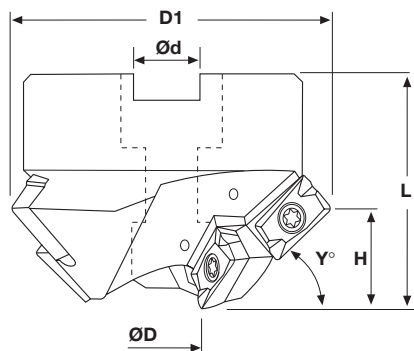
Fresa con lubrificazione interna ...  
 Milling cutter with internal coolant  
 Fräser mit innenkühlung

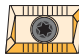

**ART. FB.035**  
 15° - 30° - 45° - 60° - 75°

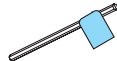
Codice d'ordine Bestell-Nr Order No.	(mm) Dimensioni - Abmessungen - Dimensions										
	D	D1	d	L	Y°	H	Z	K			
FB.035.001 W	35	75	27	50	45°	21,5	6	3	APKT1604 APFT1604 APHX1604	VT 40	BT 15
FB.035.002 W	35	62	27	50	60°	26,5	6	3			
FB.035.003 W	35	85	27	50	30°	15,0	6	3			
FB.035.004 W	35	90	27	50	15°	8,0	6	3			
FB.035.005 W	35	45	22	60	75°	29,5	6	3			

K= Fattore d'avanzamento / Vorschubfaktor / Factor of feed  
 Disponibile a richiesta anche FB 035 con gradazioni differenti Y°  
 Lieferbar auf anfrage FB 035 mit verschiedener graden Y°  
 Available on request FB 035 with different grades Y°

Fresa con lubrificazione interna ...  
 Milling cutter with internal coolant  
 Fräser mit innenkühlung



# Frese per lamatura ed alesare

## Senkungsfräser und zum Ausbohrungen

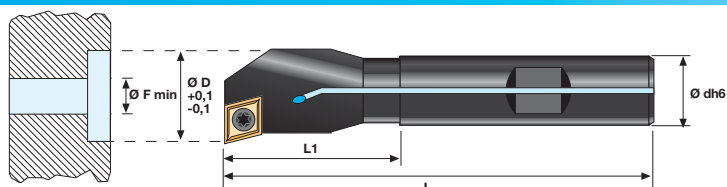
### Spot facing and boring milling cutter



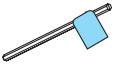

ART. **380 W**

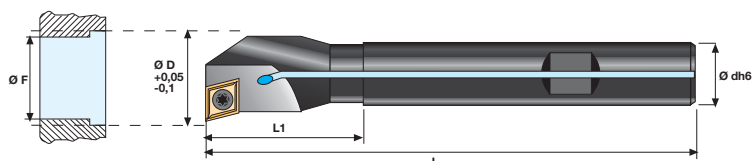
Codice d'ordine Bestell-Nr. Order No.	(mm) Dimensioni - Abmessungen - Dimensions								
	Ø D	L	L1	dh 6	Ø F min	Z			
380 WW D.10	10	85	15	12	4	1	CCGT 060204 CCMT 060204	VT 25	BT 08
380 WW D.11	11	85	15	12	4	1			
380 WW D.12	12	85	18	12	4	1			
380 WW D.13	13	85	23	12	5	1			
380 WW D.14	14	85	23	12	5	1			
380 WW D.15	15	85	30	12	5	1			
380 WW D.16	16	85	30	12	5	1			
380 WW D.17	17	95	30	16	5	1	CCGT 09T304 CCMT 09T304	VT 40	BT 15
380 WW D.18	18	95	40	16	5	1			
380 WW D.19	19	95	40	16	5	1			
380 WW D.20	20	95	40	16	5	1			
380 WW D.21	21	95	42	16	5	1			
380 WW D.22	22	95	42	16	6	1			
380 WW D.23	23	95	42	16	6	1			
380 WW D.24	24	95	42	16	6	1			
380 WW D.25	25	95	42	16	8	1			
380 WW D.26	26	120	56	20	8	1			
380 WW D.27	27	120	56	20	8	1			
380 WW D.28	28	120	56	20	10	1			
380 WW D.29	29	120	56	20	11	1			
380 WW D.30	30	120	56	20	12	1			
380 WW D.31	31	120	56	20	14	1			
380 WW D.32	32	120	56	20	15	1			
380 WW D.33	33	120	56	20	15	1			

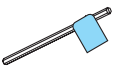

ART. **385 W**

Codice d'ordine Bestell-Nr. Order No.	(mm) Dimensioni - Abmessungen - Dimensions								
	Ø D	L	L1	dh 6	Ø F	Z			
385 WW D.10	9,8	90	23	8	10	1	CCGT 060204 CCMT060204	VT 25	BT
385 WW D.11	10,8	105	24	10	11	1			
385 WW D.12	11,8	105	25	10	12	1			
385 WW D.13	12,8	105	26	10	13	1			
385 WW D.14	13,8	110	27	12	14	1			
385 WW D.15	14,8	120	28	12	15	1			
385 WW D.16	15,8	125	29	12	16	1			
385 WW D.17	16,8	140	30	16	17	1			
385 WW D.18	17,8	140	31	16	18	1			
385 WW D.19	18,8	150	32	16	19	1			
385 WW D.20	19,8	150	33	16	20	1			
385 WW D.21	20,8	160	34	16	21	1	CCGT 09T304 CCMT09T304	VT 40	BT 15
385 WW D.22	21,8	160	35	20	22	1			
385 WW D.23	22,8	165	36	20	23	1			
385 WW D.24	23,8	170	37	20	24	1			
385 WW D.25	24,8	180	38	20	25	1			
385 WW D.26	25,8	185	39	20	26	1			
385 WW D.27	26,8	190	40	20	27	1			
385 WW D.28	27,8	190	41	20	28	1			
385 WW D.29	28,8	200	42	20	29	1			
385 WW D.30	29,8	200	43	25	30	1			
385 WW D.31	30,8	200	44	25	31	1			
385 WW D.32	31,8	200	45	25	32	1			

W-W = Con fori di lubrificazione  
W-W = Kühlmittelbohrung  
W-W = Coolant Bores



# Frese per lamatura 180°

180° - Senkungsfräser

180° Spot-facing end mills

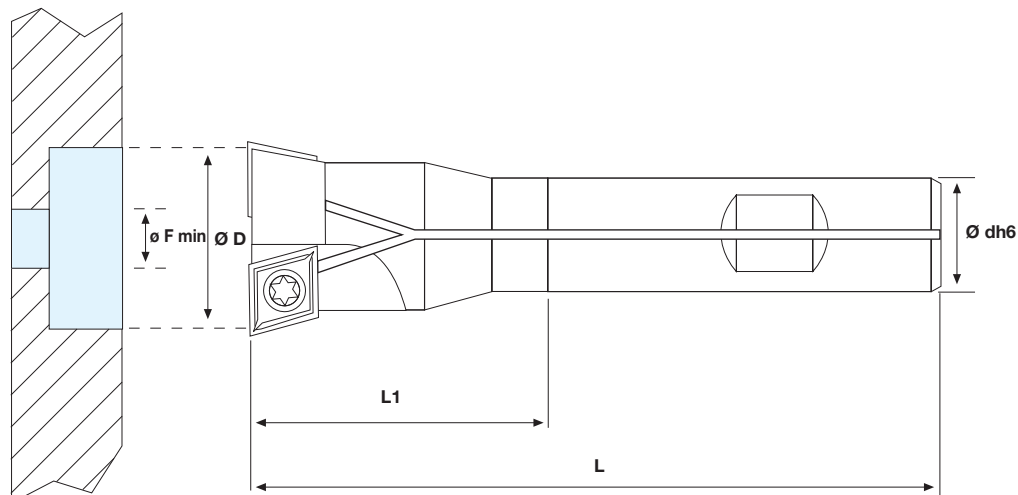
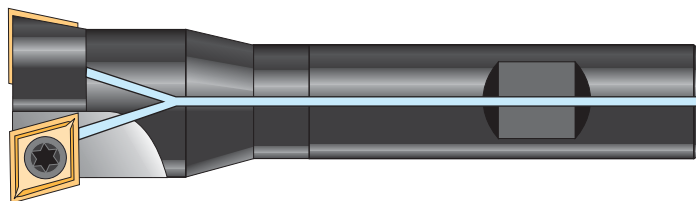
ART. 480 W

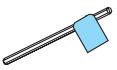

Codice d'ordine Bestell-Nr. Order No.	(mm) Dimensioni - Abmessungen - Dimensions								
	Ø D	L	L1	dh 6	Ø F min	Z			
480 WW D.16	16	92	30	12	5	2	CCMT 0602	VT25	BT08
480 WW D.17	17	94	32	16	6	2			
480 WW D.17,5	17,5	96	40	16	6,5	2			
480 WW D.18	18	97	41	16	7	2			
480 WW D.19	19	100	41	16	8	2			
480 WW D.20	20	102	41	16	9	2			
480 WW D.21	21	105	41	16	10	2			
480 WW D.22	22	110	41	16	11	2			
480 WW D.23	23	112	41	16	12	2			
480 WW D.24	24	115	41	16	13	2			
480 WW D.25	25	120	40	16	8	2	CCMT 09T3	VT40	BT15
480 WW D.26	26	125	55	20	9	2			
480 WW D.27	27	128	55	20	10	2			
480 WW D.28	28	130	55	20	11	2			
480 WW D.29	29	132	55	20	12	2			
480 WW D.30	30	134	55	20	13	2			
480 WW D.31	31	136	55	20	14	2			
480 WW D.32	32	138	55	20	15	2			
480 WW D.33	33	140	55	20	16	2			
480 WW D.34	34	140	60	25	16	2			
480 WW D.35	35	140	60	25	17	2			
480 WW D.36	36	140	60	25	18	2			
480 WW D.37	37	140	60	25	19	2			
480 WW D.38	38	140	60	25	20	2			
480 WW D.39	39	140	60	25	21	2			
480 WW D.40	40	140	60	25	22	2			
480 WW D.41	41	140	60	25	23	2			
480 WW D.42	42	140	60	25	24	2			

W-W = Con fori di lubrificazione  
W-W = Kühlmittelbohrung  
W-W = Coolant Bores

# Frese per lamatura a tirare 180°

Rückwärtssenker 180°

Back facing milling cutter 180°

ART. 360 W

NOVITÀ  
NEU  
NEW

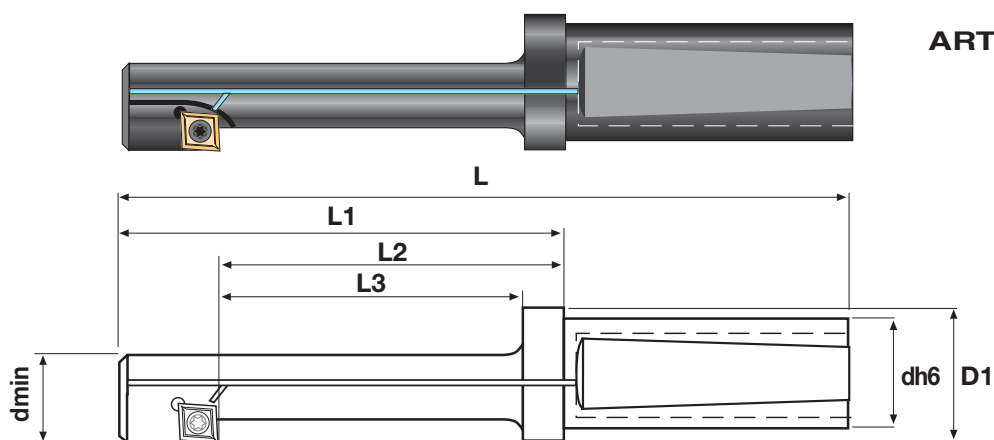

Codice d'ordine Bestell-Nr. Order No.	(mm) Dimensioni - Abmessungen - Dimensions											
	D	dmin	L	L <sub>1</sub>	L <sub>2</sub>	L <sub>3</sub>	dh6	D <sub>1</sub>	e			
360W D. 15	15	8.5	105	55	42	35	20	25	3.5	CPMT 05T1	VT 22	BT 06
360W D. 18	18	10.5	112	62	47	40	20	25	4.0			
360WW D. 20	20	13.0	117	67	52	45	20	25	3.75			
360WW D. 24	24	15.0	122	72	57	50	20	25	4.75	CCMT 060204.. CCGT 060204...	VT 25	BT 08
360WW D. 26	26	17.0	132	82	67	60	20	25	5.0			
360WW D. 30	30	19.0	142	92	77	65	20	25	6.0			
360WW D. 33	33	21.0	152	102	82	75	20	25	6.5	CCMT 09T304.. CCGT 09T304..	VT 40	BT 15
360WW D. 36	36	23.0	173	113	93	85	32	40	7.0			
360WW D. 40	40	25.0	183	123	103	95	32	40	8.0			
360WW D. 43	43	30.0	183	123	103	95	32	40	7.0			
360WW D. 48	48	33.0	223	163	143	135	32	40	8.0			

W-W = Con fori di lubrificazione  
W-W = Kühlmittelbohrung  
W-W = Coolant Bores

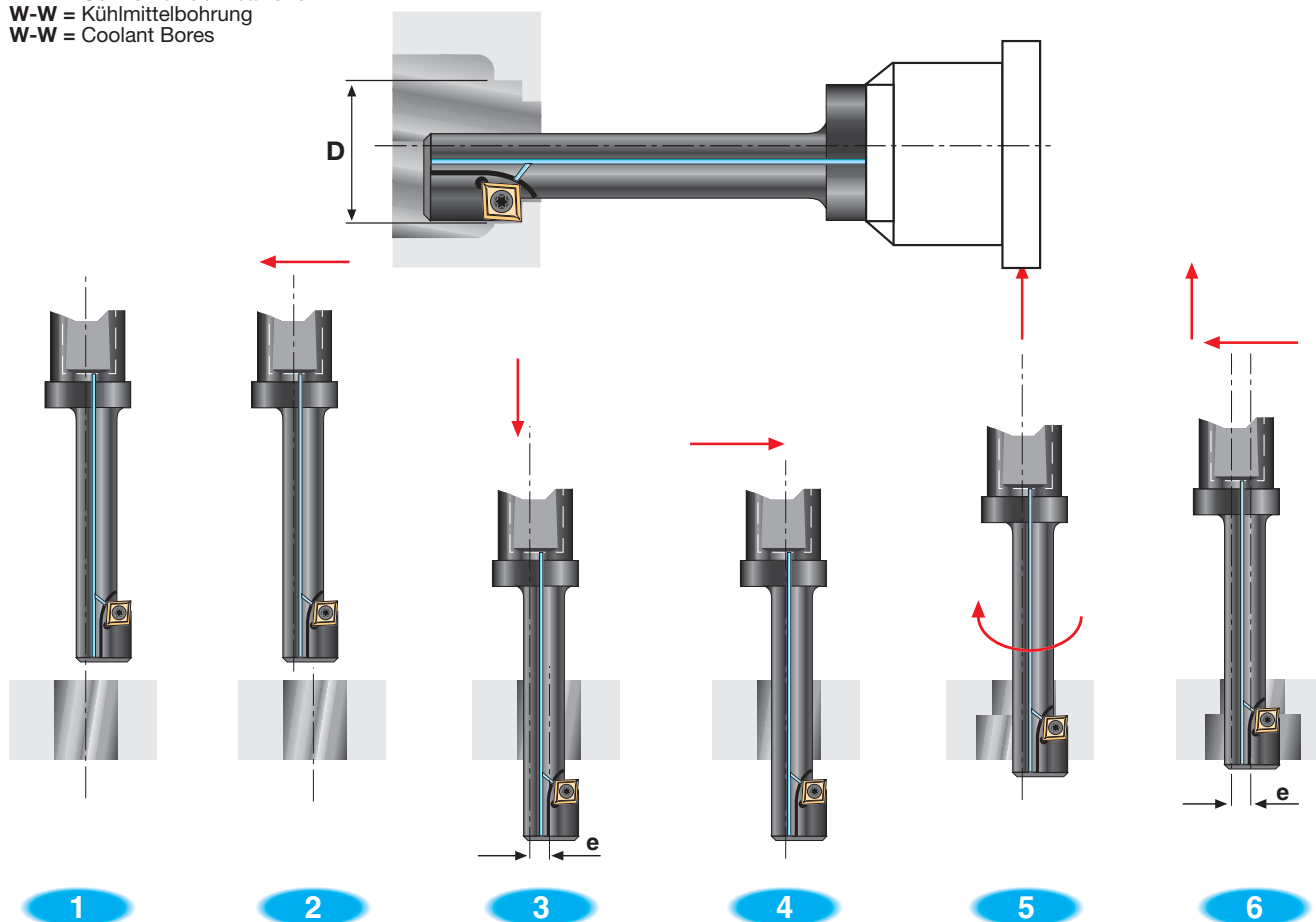



**Frese per smusso a tirare 45°**  
*Rückwärtsfräser 45°*  
 Back chamfering milling cutter 45°

**ART. 370 W**

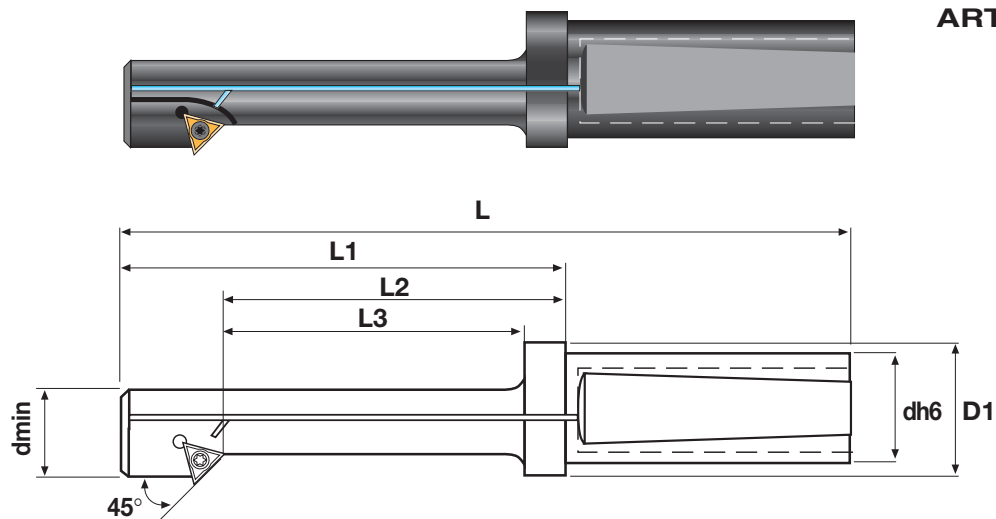

Codice d'ordine Bestell-Nr. Order No.	(mm) Dimensioni - Abmessungen - Dimensions											
	D	dmin	L	L <sub>1</sub>	L <sub>2</sub>	L <sub>3</sub>	dh6	D <sub>1</sub>	e			
370W D. 15	15	10	105	55	42	35	20	25	2.70	TCMT 0802	VT 20	BT 06
370WW D. 20	20	14	110	60	47	40	20	25	3.20			
370WW D. 23	23	17	120	70	57	50	20	25	3.20			
370WW D. 27	27	21	140	90	77	70	20	25	3.20	TCMT 1102	VT 25	BT 08
370WW D. 31	31	24	150	100	87	80	20	25	3.70			

W-W = Con fori di lubrificazione  
 W-W = Kühlmittelbohrung  
 W-W = Coolant Bores

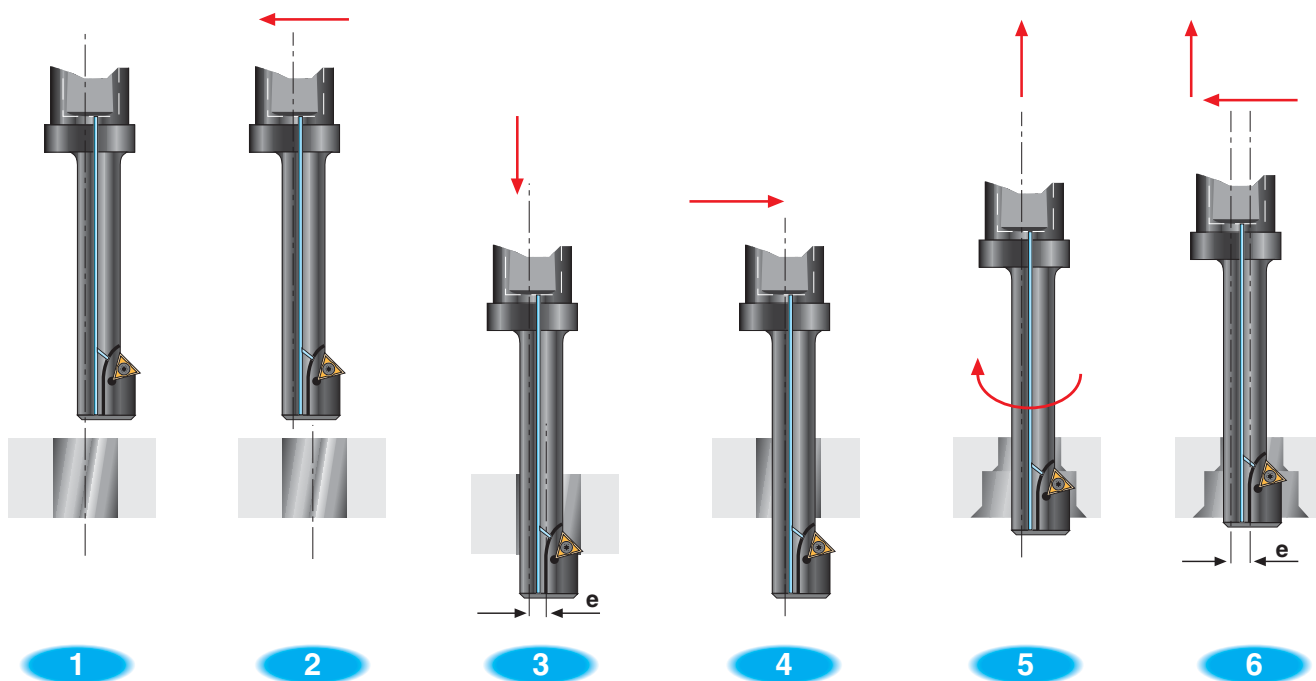
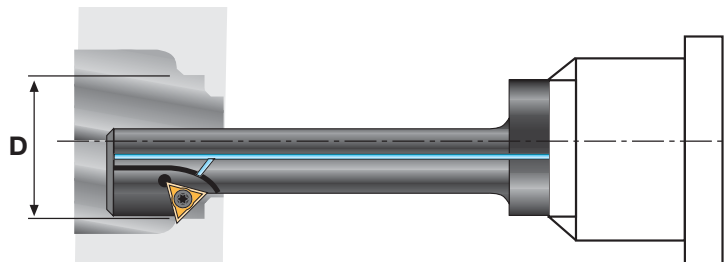

# Bareni registrabili per alesatura

## Einstellbare feinbohrstangen

### Adjustment boring bars

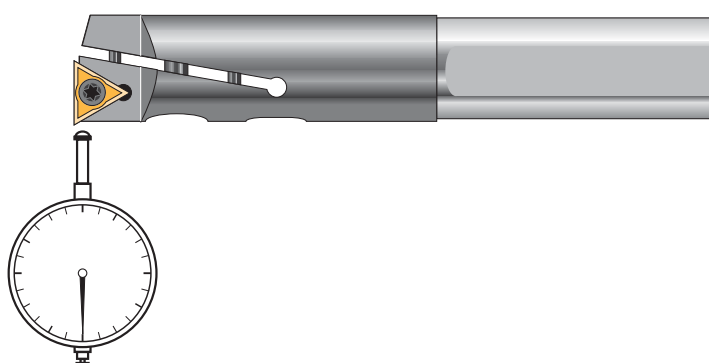
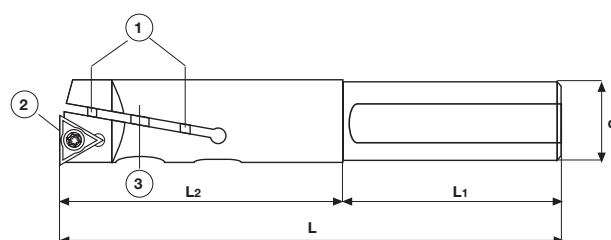
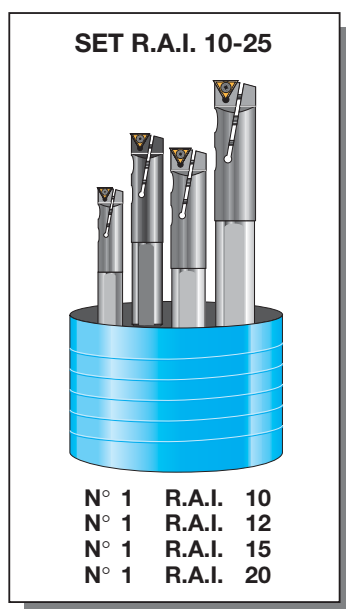

NOVITÀ  
 NEU  
 NEW

Codice d'ordine Bestell-Nr. Order No.	(mm) Dimensioni Abmessungen - Dimensions						vite regolazione 1 zug schraube 1 adjust.screw 1	vite inserto 2 wpl.schraube 2 inserts screw 2	vite fissaggio 3 druckschraube 3 clamp sciew 3	inserto wendeplatte inserts
	L	L <sub>1</sub>	L <sub>2</sub>	d	D <sub>min</sub>	D <sub>max</sub>				
R.A.I. 06	85	65	20	8	06 mm	07 mm	RE 11	VT 24	BL 11	WCMT 0201...
R.A.I. 07	90	65	25	8	07 mm	08 mm	RE 9	VT 20	BL 9	TPGX 0601 ..L
R.A.I. 08	90	65	25	8	08 mm	10 mm	RE 10	VT 20	BL 10	TPGX 0601 ..L
R.A.I. 10	100	70	30	10	10 mm	12 mm	RE 0	VT 20	BL 0	TPGX 0802 ..L
R.A.I. 12	105	70	30	12	12 mm	15 mm	RE 1	VT 20	BL 1	TPGX 0802 ..L
R.A.I. 15	110	60	50	16	15 mm	20 mm	RE 2	VT 20	BL 2	TPGX 0802 ..L
R.A.I. 20	120	60	60	20	20 mm	25 mm	RE 3	VT 25	BL 3	TCMT 1102 ...
R.A.I. 25	140	70	70	25	25 mm	30 mm	RE 4	VT 40	BL 4	TCMT 16T3 ...
R.A.I. 30	160	70	90	25	30 mm	35 mm	RE 5	VT 40	BL 5	TCMT 16T3 ...
R.A.I. 35	170	70	100	32	35 mm	40 mm	RE 6	VT 40	BL 6	TCMT 16T3 ...
R.A.I. 40	190	70	120	32	40 mm	45 mm	RE 7	VT 40	BL 7	TCMT 16T3 ...
R.A.I. 45	220	70	150	32	45 mm	50 mm	RE 8	VT 40	BL 10	TCMT 16T3 ...
R.A.I. 10 CCMT	100	70	30	10	10 mm	12 mm	RE 0	VT 20	BL 0	CCMT 0602 ...
R.A.I. 12 CCMT	105	70	30	12	12 mm	15 mm	RE 1	VT 20	BL 1	CCMT 0602 ...
R.A.I. 15 CCMT	110	60	50	16	15 mm	20 mm	RE 2	VT 20	BL 2	CCMT 0602 ...
R.A.I. 20 CCMT	120	60	60	20	20 mm	25 mm	RE 3	VT 25	BL 3	CCMT 0602 ...
R.A.I. 25 CCMT	140	70	70	25	25 mm	30 mm	RE 4	VT 40	BL 4	CCMT 09T3 ...
R.A.I. 30 CCMT	160	70	90	25	30 mm	35 mm	RE 5	VT 40	BL 5	CCMT 09T3 ...
R.A.I. 35 CCMT	170	70	100	32	35 mm	40 mm	RE 6	VT 40	BL 6	CCMT 09T3 ...
R.A.I. 40 CCMT	190	70	120	32	40 mm	45 mm	RE 7	VT 40	BL 7	CCMT 09T3 ...
R.A.I. 45 CCMT	220	70	150	32	45 mm	50 mm	RE 8	VT 40	BL 10	CCMT 09T3 ...
Serie extra lunga - Extralangue Ausführung / Extralong models										
R.A.I. 12 SL	130	70	60	12	12 mm	15 mm	RE 1	VT 20	BL 1	TPGX 0802 ..L
R.A.I. 15 SL	140	70	70	16	15 mm	20 mm	RE 2	VT 20	BL 2	TPGX 0802 ..L
R.A.I. 20 SL	150	70	80	20	20 mm	25 mm	RE 3	VT 25	BL 3	TCMT 1102 ...
R.A.I. 25 SL	170	70	100	25	25 mm	30 mm	RE 4	VT 40	BL 4	TCMT 16T3 ...
R.A.I. 30 SL	190	70	120	25	30 mm	35 mm	RE 5	VT 40	BL 5	TCMT 16T3 ...
R.A.I. 35 SL	220	70	150	32	35 mm	40 mm	RE 6	VT 40	BL 6	TCMT 16T3 ...

# Set Minimill

Codice d'ordine Bestell-Nr. Order No.	<b>SET 380 W</b>	Frese per lamatura Senkungsfräser Spot facing milling cutter
Contenuto del set - Inhalt pro Set / Set Contents		
<b>SET 380 W</b>		
1	380 WW D. 11	
1	380 WW D. 14	
1	380 WW D. 17	
1	380 WW D. 19	
1	380 WW D. 22	
1	380 WW D. 25	

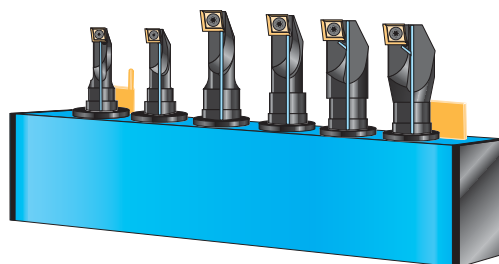

Codice d'ordine Bestell-Nr. Order No.	<b>SET 385 W</b>	Frese per alesare Fräser zum Ausbohren Boring milling cutter
Contenuto del set - Inhalt pro Set / Set Contents		
<b>SET 385 W</b>		
1	385 WW D. 10	
1	385 WW D. 12	
1	385 WW D. 16	
1	385 WW D. 20	

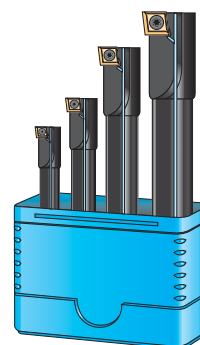

Codice d'ordine Bestell-Nr. Order No.	<b>SET 360 W</b>	Frese per lamatura a tirare Rückwärtsfräser Back facing milling cutter
Contenuto del set - Inhalt pro Set / Set Contents		
<b>SET 360 W</b>		
1	360 WW D. 18	
1	360 WW D. 20	
1	360 WW D. 24	
1	360 WW D. 26	
1	360 WW D. 30	
1	360 WW D. 33	

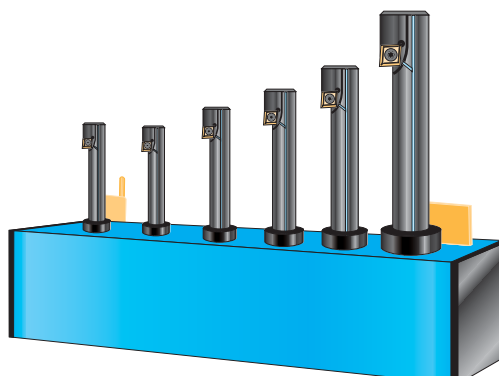

Codice d'ordine Bestell-Nr. Order No.	<b>SET 370 W</b>	Frese per smusso a tirare Rückwärtsfräser Back chamfering milling cutter
Contenuto del set - Inhalt pro Set / Set Contents		
<b>SET 370 W</b>		
1	370 WW D. 15	
1	370 WW D. 20	
1	370 WW D. 23	
1	370 WW D. 27	

